

82

Lead  
207.2



**Engitec**  
Technologies

# TILTING ROTARY FURNACE



# TILTING ROTARY FURNACE

**SCOPE:** Smelting of lead-bearing materials (paste, metallic) with fluxes

**TYPE:** Tilting 45° with double pouring system: 1) metal from dedicated channel with furnace in horizontal position and 2) slag from feeding port via furnace tilting  
Details include:

- Refractory Material of Chrome-Magnesium basis
- Oxy-fuel burner or air-fuel burner. Reverse type combustion flow
- Feeding door opening through local control panel and through remote control
- Door operation system with hydraulic unit
- Process fumes tower with refractory lining (Si-Al)
- Rotation system 0 - 1 rpm with variable speed driver (by VFD)
- Hydraulic tilting system for the furnace, with lifting cylinders and hydraulic power package
- Complete canopy hood system covering the entire furnace assembly

Furnace capacity (dm <sup>3</sup> molten Pb)	Feeding rate (ton of paste /cycle)	Burner Power (kW)
3000	13 - 15	1800
5000	20 - 22	2600
8000	25 - 30	3400

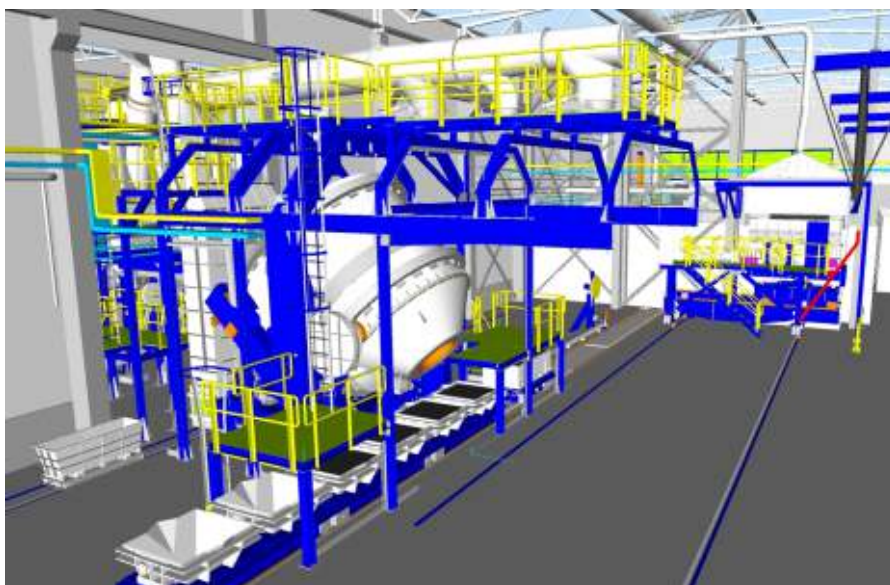

*Slag tapping  
from front port  
by tilting*



*Lead tapping  
from spout*



**Engitec Technologies**

Via Borsellino e Falcone 31 - 20026 Novate Milanese (MI) - Italy  
Phone + 39 02.382071 r.a. - Fax +39 02.3562086  
info@engitec.com - www.engitec.com

